

Fact Sheet

GLM-Emaxx automac

BIZERBA

GLM-Emaxx automac ... higher performance, increased convenience, and even more functionality. In combination with a packaging machine, GLM-Emaxx automac fulfils both current and future requirements with its Intel® Atom™ based hardware.



More information
High performance
with a wide range of
solutions and options.

Specifications	Facts	Details
Weighing range LA18 A/M	6 kg / 2 g 6/15 kg // 2/5 g	Minimum load 40 g / verification scale intervals 3000 Minimum load 40 g / verification scale intervals 2 x 3000
Printing technology	Printing method Resolution Print width Print speed Label clearance	Thermal direct (optional thermal transfer) 8 dot/mm (optional 12 dot/mm) 80 mm (optional 104) Max. 200 mm/s 120 mm
Printer	Label size Label roll Thermal transfer ribbon	Min. 30 mm (W) x 30 mm (L) Max. 100 mm (W) x 100 mm (L) Core 40 mm opt. 76 mm, outer diameter max. 300 mm Core diameter 25.4 mm Outer diameter 81 mm
Barcode versions	All common barcode versions	EAN/UPC 8, EAN/UPC 13, EAN/UPC 128, Code 2/5 int. Code 39, Code 128, GS1-128, PDF 417, PDF 417 with AI, GS1 DataBar Omni, GS1 DataBar, Datamatrix, QR code
Mains voltage	230 V/50-60 Hz, 110 V/60 Hz	
Operating temperature	0 °C to 40 °C	stand-by up to -10 °C
Humidity	20-90 % non-condensing	
Protection class	IP 20	
Memory	2 GB	
Operating panel	Keyboard operation 7" color display	Optional GT-12E or GT-12C 12" LCD display with touch screen function
Options	Facts	Details
Thermal transfer device		Printing is done via thermal transfer ribbon.
Compressor		for type Elix Plus/ZX

Infographic



Symbols



Protection class IP 54



Protection class IP 20



Tool-free maintenance



WS-food



UNICODE

Dimensions

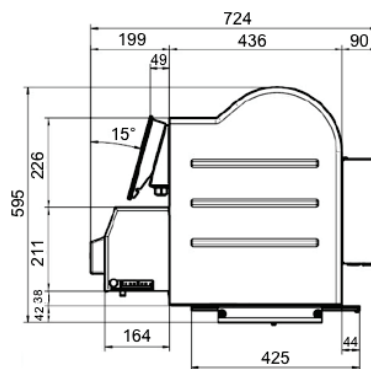
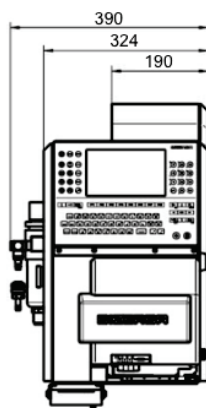

GLM-Emaxx automatic

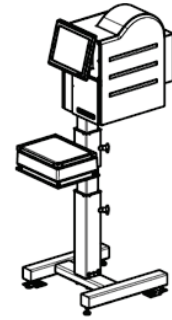
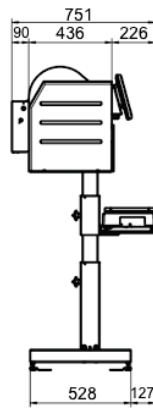
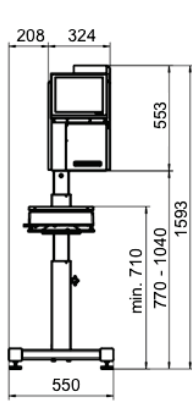

GLP-Emaxx variant with stand

Bizerba GmbH & Co. KG

Wilhelm-Kraut-Straße 65
72336 Balingen
Germany
T +49 7433 12-0
F +49 7433 12-2696
marketing@bizerba.com

www.bizerba.com